

LONGITUDINAL SECTION

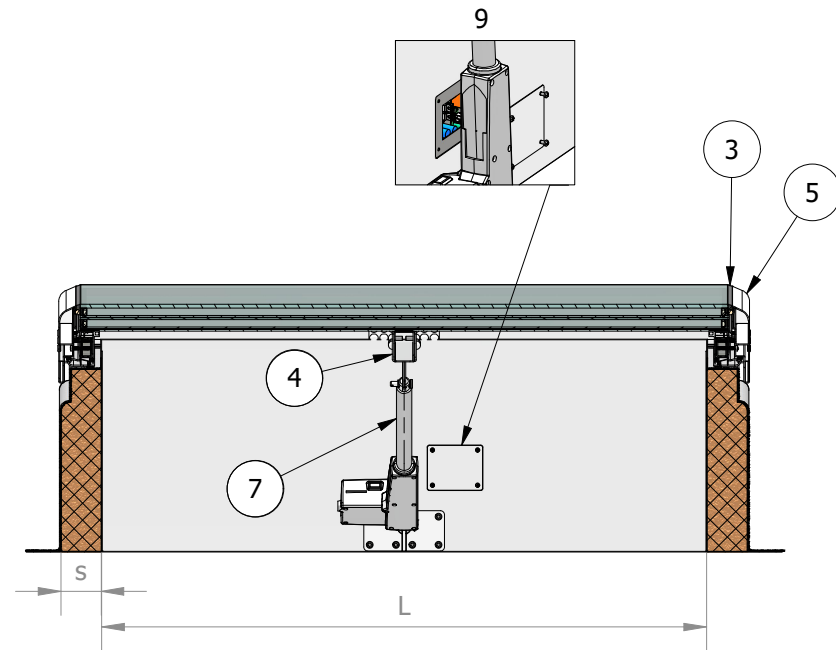

CROSS SECTION

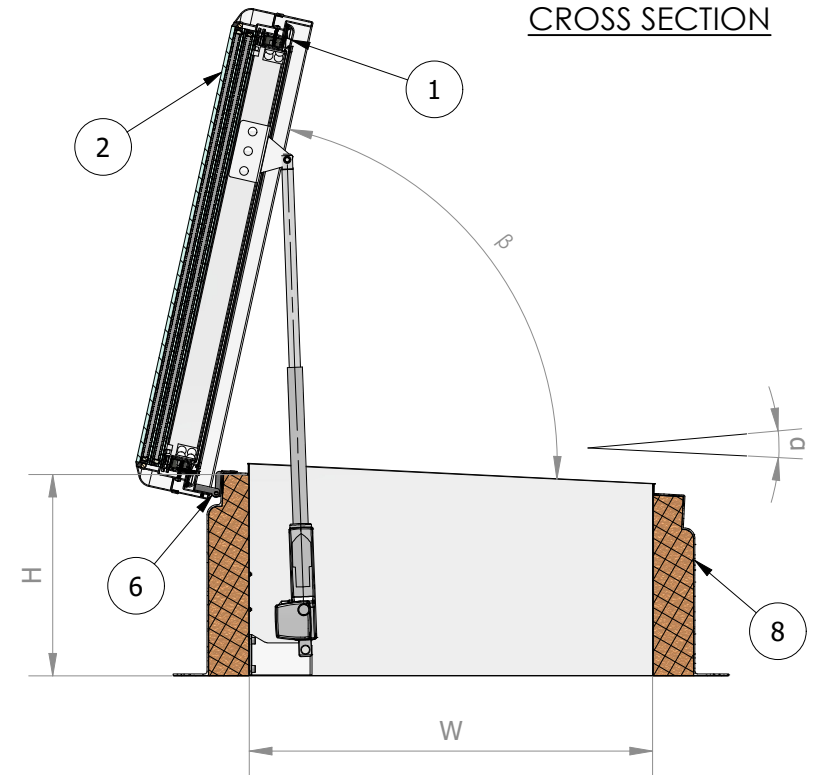

SPECIFICATIONS

1. INTERNAL FRAMES IN WHITE PVC; 2. MULTILAYER GLASS SURFACE (TOUGHENED + LOW-E), 2 OR 3 LAYERS OPTIONS AVAILABLE; 3. STRUCTURAL SEAL; 4. SUPPORT CROSSBEAM; 5. EXTERNAL WHITE POWDER COATED METAL PROFILES (OTHER RAL COLORS AVAILABLE); 6. STAINLESS STEEL HINGES; 7. DC ACTUATOR (24 V, MAX PUSH FORCE 5000 N); 8. UPSTAND (STANDARD THICKNESS 60 mm, CUSTOMIZABLE OPTIONS AVAILABLE); 9. OPTIONAL: CONCEALED ELECTRONICS BOX (230 V AC CONVERSION KIT AVAILABLE).

PARAMETERS

L = DAYLIGHT OPENING, LONG SIDE (MAX 120 cm IN THIS CONFIGURATION)
W = DAYLIGHT OPENING, SHORT SIDE (MIN 70 cm ; MAX 120 cm)
 α = ABOUT 3° SLOPE FOR WATER OUTFLOW
 β = ABOUT 80° OPENING ANGLE
H = UPSTAND HEIGHT (MIN 40 cm)
s = CUSTOMIZABLE INSULATION THICKNESS

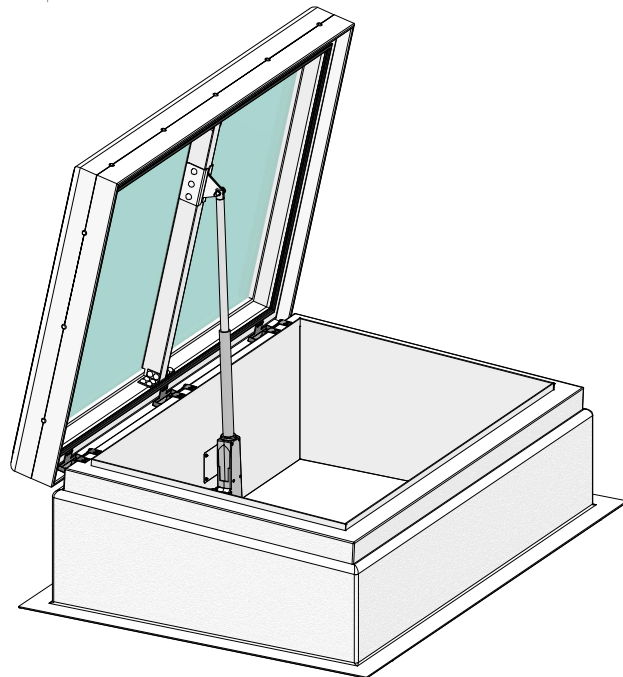

R²DACH

ROOF ACCESS - FLATLIGHT

Scale	Format	Description:
1 : 15	ISO A4	CENTRAL ACTUATORS
<small>This drawing is the property of Tageslichttechniken and incorporates information which is proprietary. Publication and/or public distribution in whole or in part is expressly prohibited without the prior written consent of Tageslichttechniken. The information contained herein remains the property of Tageslichttechniken. All rights reserved.</small>		